

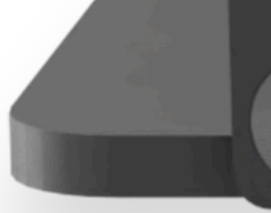

link



Quick Look

Number of Ethernet WAN port

1 / 0 (2.5G)

[1]

[1] WAN port(s) can be configured as LAN port(s) via the Web Admin. Ethernet ports include surge and ESD protection circuits to protect against over-voltage transients.

Number of Ethernet LAN port

2 / 3 (GE)

[1]

[1] WAN port(s) can be configured as LAN port(s) via the Web Admin. Ethernet ports include surge and ESD protection circuits to protect against over-voltage transients.

Router Throughput

1Gbps

SpeedFusion VPN Throughput (No Encryption)

400Mbps

SpeedFusion VPN Throughput (256-bit AES)

200Mbps

Number of Cellular Modem

1

Interfaces

Maximum Ethernet WAN / LAN port configuration

1 WAN with 2 LAN, 0 WAN with 3 LAN

SFP LAN / WAN

No
Serial Interface
No
Wi-Fi AP
Yes
Wi-Fi WAN
Yes
USB WAN
No
Module Expansion
No

Performance

Number of Recommended Users
1-150
Maximum Number of AP Supported
30 / 50
[2]
[2] 50 AP is available as a license add-on (AP-LC-50).

Wireless details

Cellular Modem Category options
1x 5G
5G support
Yes
SIM Slots
2
SIM Card Size
Nano-SIM (4FF)
Wi-Fi Radio
Dual (2.4GHz + 5GHz), 2x2 Wi-Fi 6
Wi-Fi Antenna Transmit Power (2.4GHz, single chain)
24dBm
Wi-Fi Antenna Transmit Power (5GHz, single chain)
26dBm
Multiple SSIDs
16
GPS
Yes
RemoteSIM (used in SIM Injector)
Yes (HW2+)
FusionSIM
Yes (HW2+)
Peplink eSIM Data Plans
Yes
[3]
[3] Require Firmware 8.3.0 or above.

BYO eSIM
Yes
[4]
[4] Require Firmware 8.4.0 or above.

Features

SpeedFusion Hot Failover
Yes
SpeedFusion Smoothing
Yes
SpeedFusion Bandwidth Bonding
Yes
SpeedFusion Connect
Yes
[5]
[5] PrimeCare subscription includes 1TB/year complimentary SpeedFusion Connect Usage data.
SpeedFusion Relay Mode (Server)
Yes
Drop-In Mode
Yes
High Availability
Yes
Peplink AP Series Management
Yes
Remote AP & Multiple Config Profiles Management
No
WAN as LAN
Yes
LAN Bypass
No
InTouch
Yes
Virtual WAN
Yes
[6]
[6] 1 Virtual WAN complimentary with active PrimeCare. Up to 3 Virtual WAN upon purchasing Virtual WAN Activation Licence.
Synergy Mode (Controller)
Yes
Synergized Device
Yes
Application and Web Blocking
Yes
Web Content Filtering
Lite
IP Passthrough
Yes
IPv6
No
x.509 Certificate
Yes
[7]
[7] Require IPsec X.509 Certificate License Key
Captive Portal
Yes
GPIO
Yes
Ignition Sensing
Yes
Netflow support
Yes
LACP (802.3ad) NIC Bonding
Yes
[8]
[8] Require Firmware 8.4.1 or above.
Internal Storage for Edge Computing
No
External Storage via USB Port
No
Dead Reckoning
Yes

Core Functionality

Inter-VLAN Routing

Yes
802.1q VLANs Supported
16
Port-Based VLAN
Yes
Load Balancing Algorithms
8
Load Balancing & Failover
Yes
Inbound Load Balancing
No
InControl 2 Cloud Management
Yes
InControl GPS Fleet Management
Yes

Advanced QoS Functionality

Bandwidth Usage Monitoring
Yes
QoS for VoIP and E-Commerce
Yes
User Groups Bandwidth Control
Yes

VPN Functionality

SpeedFusion VPN
Yes
Number of SpeedFusion VPN Peers
2 or 5
[9]
[9] 2 SpeedFusion VPN Peers are enabled by default. 5 SpeedFusion VPN Peers are enabled with PrimeCare Subscription, complimentary for the first year.
IPsec VPN
Yes
Number of IPsec Tunnels
5
L2TP VPN / Open VPN / PPTP VPN Server
Yes
Maximum PPTP / L2TP / OpenVPN Users
3
Remote RADIUS / LDAP authentication in Remote User Access
No
Number of OpenVPN Tunnel (Site to Site)
5
Number of GRE Tunnel (Site to Site)
5

Hardware

Enclosure
Indoor, Metal
4pin Molex Micro-Fit Connector
Yes
Terminal Block Power Connector for Mobile / Vehicular Deployment
No
AC Adapter or PSU
AC Input 100V–240V, DC Output 12V 2A
Input voltage
DC 10–30V
PoE Input
No
PoE Output
No
USB Power Input
No
Nominal Power Consumption
8W
Maximum Power Consumption
19W
Dimensions in inches
5.78 x 5.08 x 1.15 inches
Dimensions in mm
146.8 x 129 x 29.3 mm

Weight (Pound)

1.5 pounds

Weight (Gram / Kilogram)

680 grams

Operating Temperature

-40°–149°F, -40°–65°C

Humidity

15%–95% (non-condensing)

Rack-mount

No

Dual Hot Swap Power Supply

No

Warranty Info

Warranty

1-Year Limited Warranty